

Spreader Plate Installation

Usually it is required that there are at least 5 courses of bricks above where the awning is mounted. In instances where this is not possible, spreader plates can be used to spread the loading down the wall.

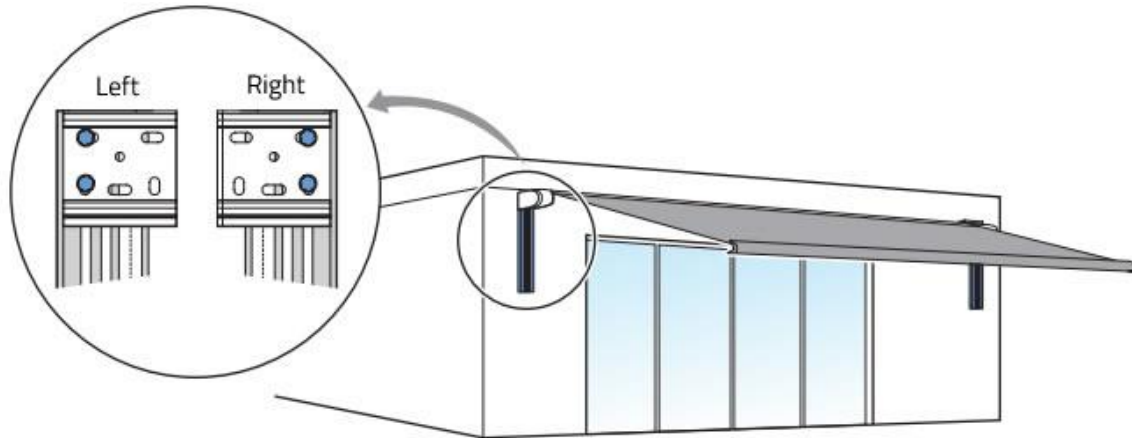

Mounting the Spreader Plates

Follow the steps below to install the spreader plates:

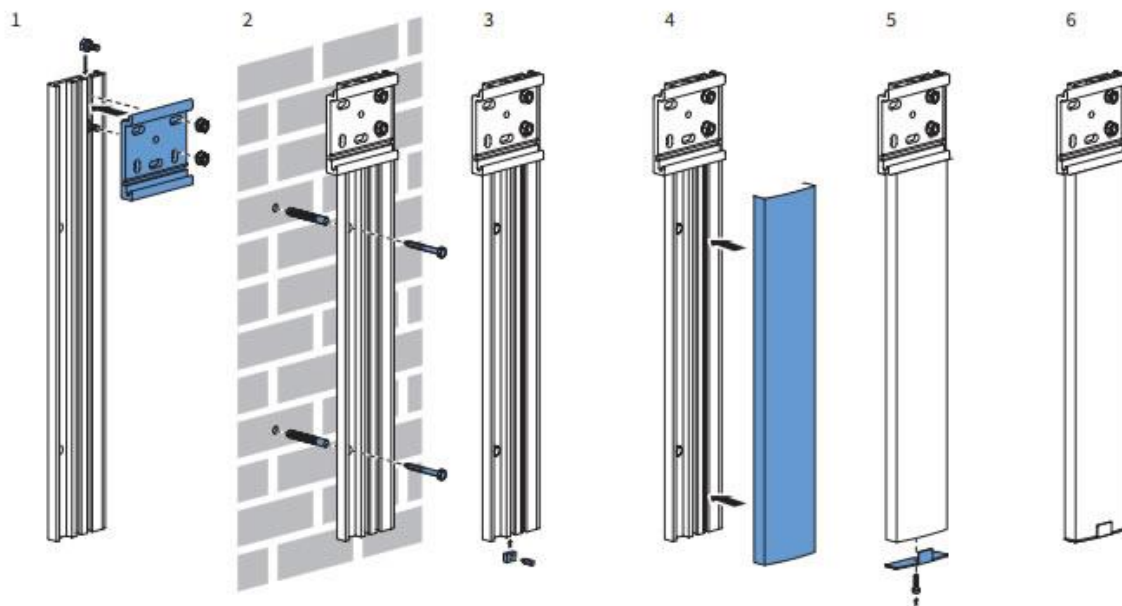

1. Attach the wall brackets to the spreader plates using the two supplied bolts. Two fixings are adequate due to the way the spreader plates spread the loading.

2. Measure the spreader plates carefully on the wall. Take into account the placement of the wall brackets on the plates. When fixing to solid brick, using the fixings provided, drill the spreader plate so the fixing goes into the centre of the brick. Three to four fixing points, spread along the spreader plate is perfectly adequate.
3. Insert the block in the bottom of the plate to allow for the cover to be fixed.
4. Place the cover over the lower part of the spreader plate.
5. Install the bottom bracket and screw into the block installed in figure 3.
6. The mounting of the wall brackets on the wall strips is done. You can now proceed with the installation of the awning.

Centre brackets

When installing an awning with a centre bracket it is not necessary to install a full spreader plate on the centre fixing. Using a small section of the spreader plate material to pack out the centre bracket it perfectly acceptable.